

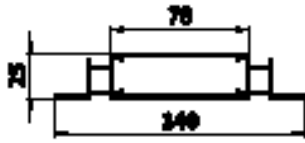

Vertical base profile, effective width 78 mm.

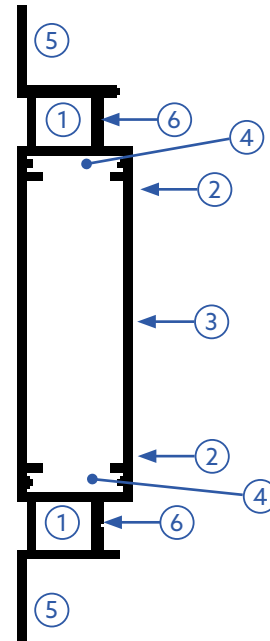

1	FACAFIX screw channel, horizontal & diagonal (30°)
2	Double-sided tape zone / adhesive zone
3	Visual centre line
4	Zone for connector / spacer
5	Screw lips for additional structures & double support structures
6	Screw direction



The BFP-200 profile has been developed **for vertical use** in combination with Facafix facade screws (all diameters). The profile can be used to construct both single and multiple support structures. This profile has a working **width of 78 mm** and is suitable for facade systems that **do not require a wide vertical support structure, or as an intermediate support for wide facade cladding**.

The pre-formed channels for the Facafix facade screws have also been developed and tested (tensile tests) for these profiles to ensure perfect thread engagement and adhesion between the Facafix screw and the aluminium profile. The FACAFIX screw channels on this profile are used **for both the horizontal Facafix facade screws and the diagonal Facafix facade screws (30°)**. Facade cladding requiring a wider profile can use the **alternative BFP-210 profile**.

Using the **connectors/spacers (BFA-501)**, these profiles can be coupled together seamlessly to ensure **straightness**. These connectors/spacers (BFA-501) also ensure a guaranteed gap of 10 mm **to accommodate expansion**.

This profile is available in standard lengths or cut to size, pre-anodized black or unfinished. The profiles can be custom-machined for specific projects using CNC machining. Please contact our services if required.

BFP-200	Sawing length (mm)	No treatment	Anodisation black	Standard CNC processed
BFP-200-B6500	6500	•		
BFP-200-B3250	3250	•		
BFP-200-ANB6500	6500		•	
BFP-200-ANB3250	3250		•	